

3/32" ply

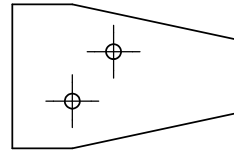

1/32" Ply

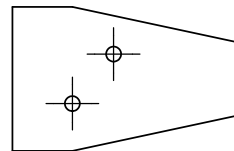
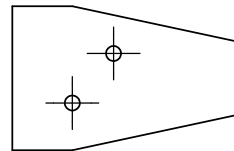
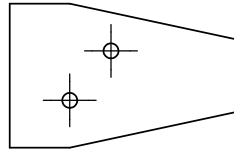
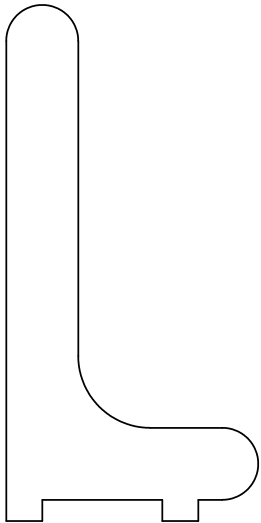

1/16" ply

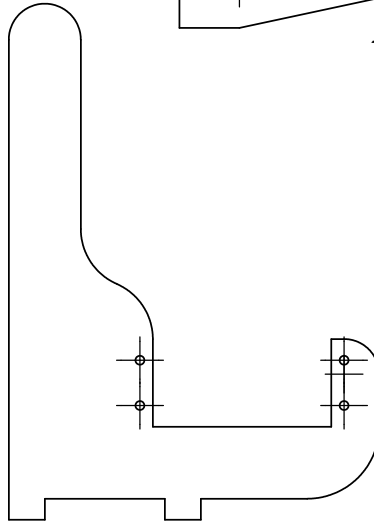

1/16" ply

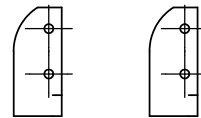

3/32" ply

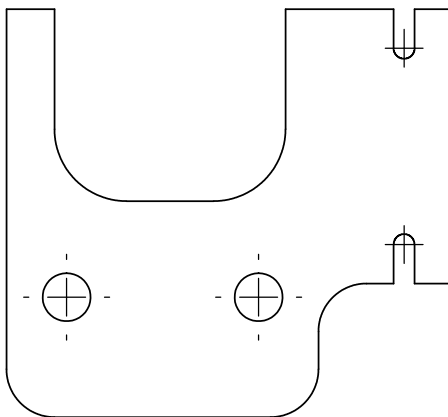

3/32" ply

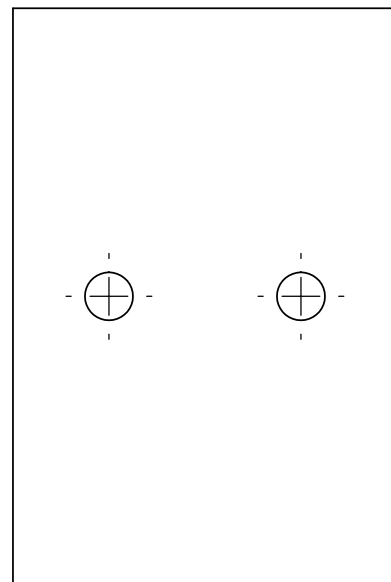

1/32" ply

<div>COPYRIGHT AND DISTRIBUTION NOTICE</div> <div>This drawing is copyright Kevin R. Hanes, 2007. You are free to copy and/or distribute this drawing provided credit is give to the copyright holder, no modification is made to the drawing and you charge no money for it.</div>	AUTHOR		Ply for Tail Feathers			
	Kevin R. Hanes					
	MATERIAL					
	Aircraft grade plywood (thickness as noted)					
	DIMENSIONS ARE IN INCHES					
COMMENTS:		FILE		Tail Feather Ply		REV.
		SCALE: 1:1		SHEET 1 OF 1		